

PART OF A PLANNED UNIT DEVELOPMENT
"INDIAN HEAD SECTION ONE"
 DEMING A RE-SUBDIVISION OF A PORTION OF TRACTS L & S-D
 BOUNDARY PLAT OF OROLE COUNTY
 PLAT BOOK 32, PAGES 175-179
 SECTIONS 14 & 25, TOWNSHIP 47 SOUTH, RANGE 41 EAST
 PALM BEACH COUNTY, FLORIDA

SHEET 2 of 4

95

This Instrument Prepared By:
BROOKS & FARINA, INC.
 ENGINEERS, PLANNERS, SURVEYORS
 CORAL SPRINGS, FLORIDA
 BY: K.M. KIRK, P.L.C.

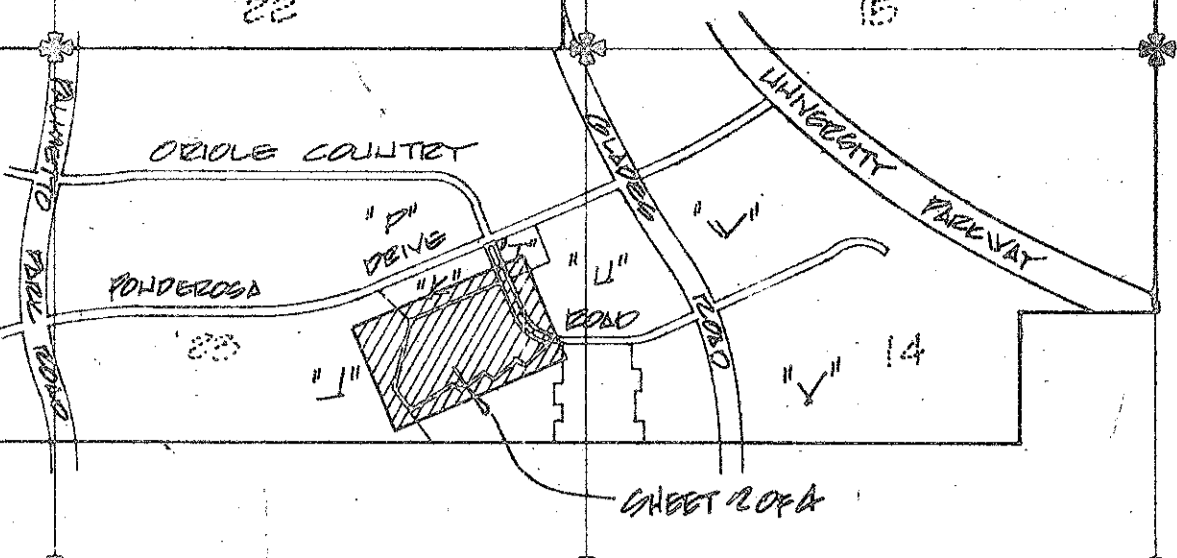
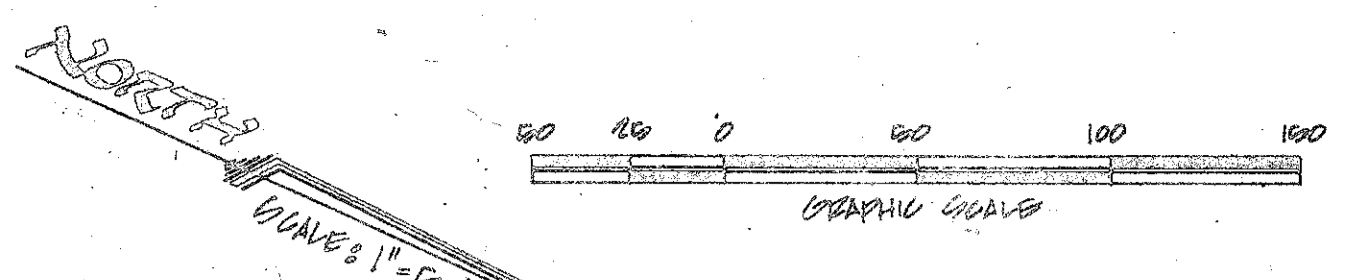

0275-317